

# 800 Series 120lt Bin Surround

Model 812 - 800 Series High Pyramid Cover 120lt Bin Surround  
(Multi-Bay)

**DRAFFIN**  
Street Furniture



800 series Bin Surrounds from Draffin Street Furniture are a "best in class" panel style bin surround. While many manufacturers have copied this style, none match Draffin Street Furniture's quality and options offered.

## Size

- 120lt

## Number of Bays *(Joined Together)*

- Single Bay
- Double Bay
- Triple Bay

## Cover Style

- High Pyramid

## Cover Material

- Powdercoated Mild Steel *(See Colour Guide)*
- 304 Stainless Steel
- 316 Stainless Steel

## Panel Material

- Powdercoated Mild Steel *(See Colour Guide)*
- 304 Stainless Steel
- 316 Stainless Steel

## Other Options

- S/S Cam Lock *(Replaces Slam Lock)*
- Magnetic Door Latches
- Ashtray Module
- Dog Bag Dispenser
- Perforations *(See Perforation Guide)*
- Laser Cut Logos
- Logo Backing Plates
- Coloured Face Plates Decal
- Communication Signage *(See Signage Guide)*

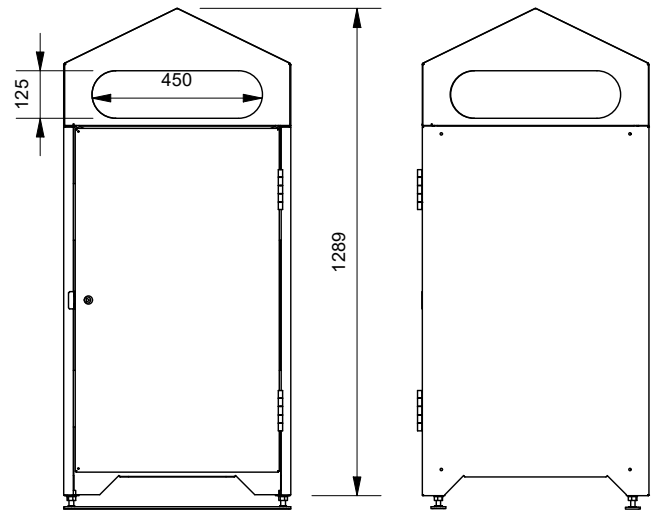
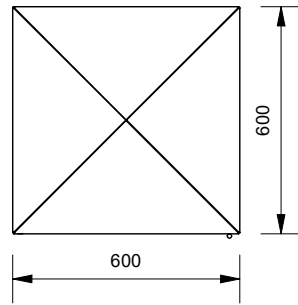

## High Pyramid Cover Openings

### Frogmouth Opening

with angled chute to direct refuse into wheelie bin

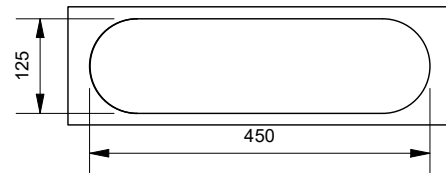

### Recycle Opening

with heavy-duty rubber escutcheon (Rosette)

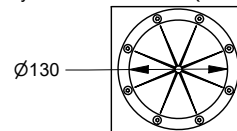

### Recycle Opening without Rosette

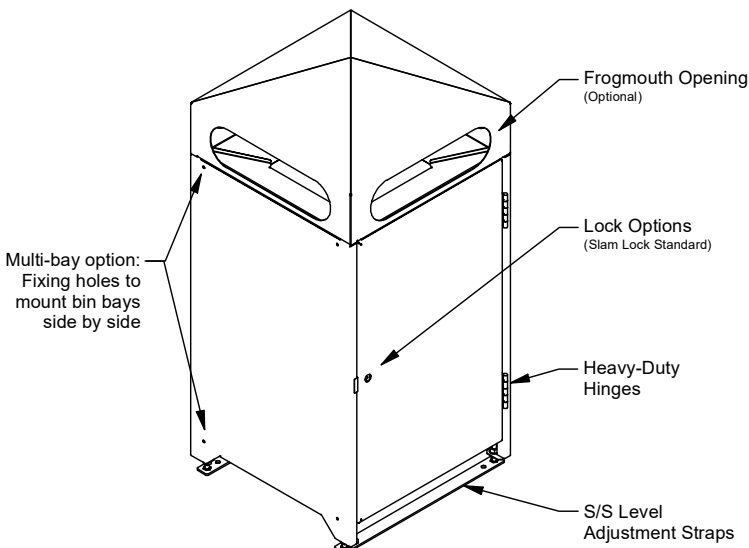
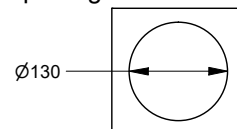

More information:

Go to the website for spec inspiration.  
**812 - 120lt 800 Series High Pyramid Cover Bin Surround**  
<https://draffin.com.au/product/800-series-with-high-pyramid-cover/>

**Colour Guide**

<https://draffin.com.au/colour-guide/>

**Signage Guide**

<https://draffin.com.au/signage-guide/>

**Stainless Steel Guide**

<https://draffin.com.au/stainless-steel-guide/>

# 800 Series 240lt Bin Surround

Model 852 - 800 Series High Pyramid Cover 240lt Bin Surround  
(Multi-bay)

**DRAFFIN**  
Street Furniture



800 series Bin Surrounds from Draffin Street Furniture are a "best in class" panel style bin surround. While many manufacturers have copied this style, none match Draffin Street Furniture's quality and options offered.

## Size

240lt

## Number of Bays *(Joined Together)*

- Single Bay
- Double Bay
- Triple Bay

## Cover Style

High Pyramid

## Cover Material

- Powdercoated Mild Steel *(See Colour Guide)*
- 304 Stainless Steel
- 316 Stainless Steel

## Panel Material

- Powdercoated Mild Steel *(See Colour Guide)*
- 304 Stainless Steel
- 316 Stainless Steel

## Other Options

- S/S Cam Lock *(Replaces Slam Lock)*
- Magnetic Door Latches
- Ashtray Module
- Dog Bag Dispenser
- Perforations *(See Perforation Guide)*
- Laser Cut Logos
- Logo Backing Plates
- Coloured Face Plates Decal
- Communication Signage *(See Signage Guide)*

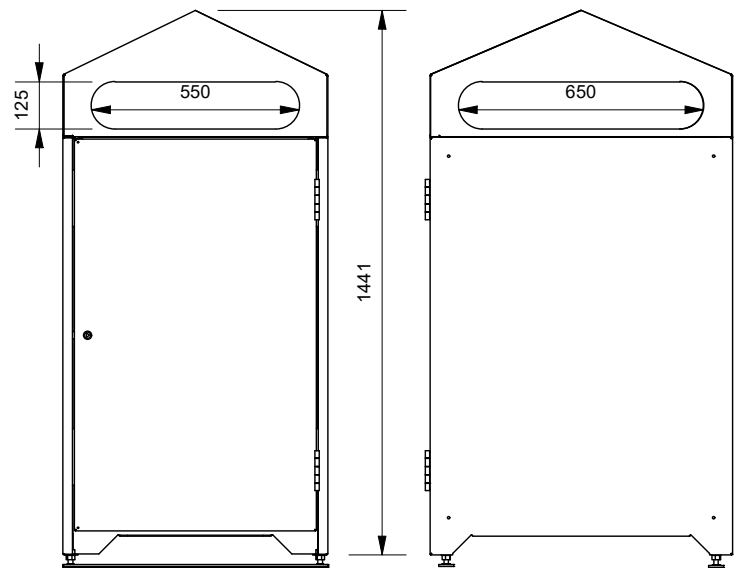
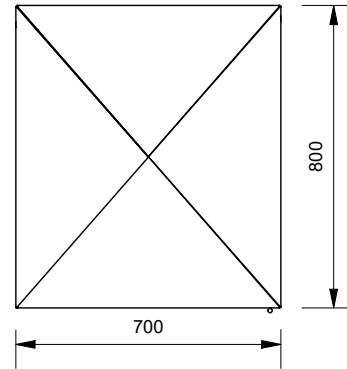

High Pyramid Cover Openings

### Frogmouth Opening

with angled chute to direct refuse into wheelie bin

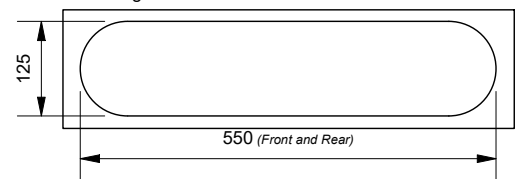

### Recycle Opening

with heavy-duty rubber escutcheon (Rosette)

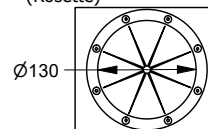

### Recycle Opening

(without Rosette)

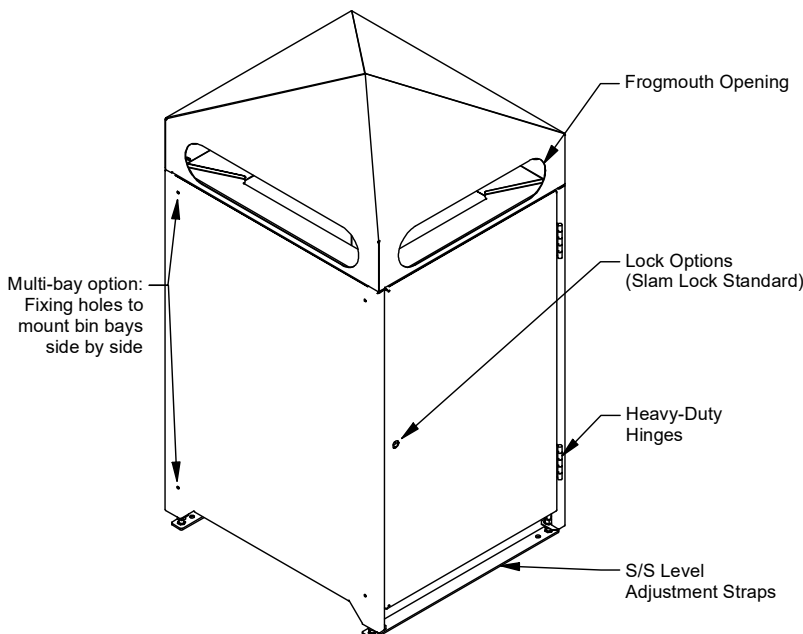
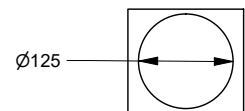

More information:  
Go to the website for spec inspiration.  
**852 - 240lt 800 High Pyramid Cover Bin Surround**  
<https://draffin.com.au/product/800-series-with-high-pyramid-cover/>

**Colour Guide**  
<https://draffin.com.au/colour-guide/>

**Signage Guide**  
<https://draffin.com.au/signage-guide/>

**Stainless Steel Guide**  
<https://draffin.com.au/stainless-steel-guide/>

# 800 Series Bin Surround Installation

## Installation Guide - 800 Series High Pyramid Cover Bin Surround (Multi-bay)



### 800 Series Multi-bay feature

Each 800 Series bay provides four mounting holes on each of the side panels to fix multiple bays side by side.

(shipped as single bay for assembly onsite - fasteners supplied with every 800 series bin surround)

Multi-bay applications include:

- extra capacity
- waste separation

**4.** Place bin surround(s) in desired final location (with regard to final positioning on slab using detail indicated on "leveling strap" diagram (bottom, right))

**5.** Using Leveling Strap mounting holes as a template, drill ground surface to suit chosen ground anchors then fit ground anchors.

**6.** Once the leveling straps are fixed to the surface, adjust the leveling nuts while the locking nuts are loose to level the end opposite the door. Ensure adjustment is locked down using lock nuts.  
(Loose lock nuts may provide a false level)

**7.** Level the door side so that the whole surround is level and the door gaps are parallel and even all around, and lock down after adjustment.

**8.** Recheck all levels and door gaps and retighten lock nuts on leveling straps.

**1.** Bring Bays together

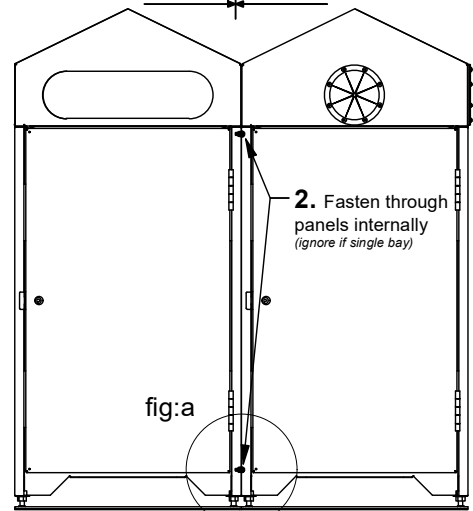

**3.** Join as many bays together as needed. (ignore if single bay)

\*Bay openings can be configured in any order and can face the front or the back

fig:a

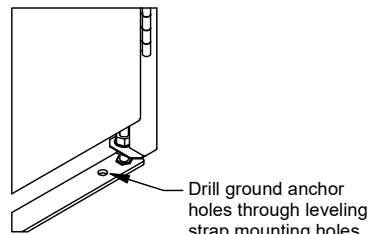
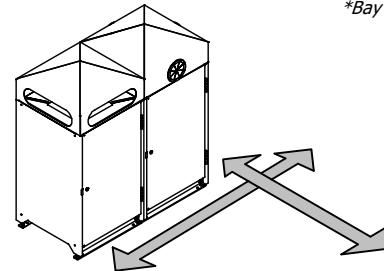
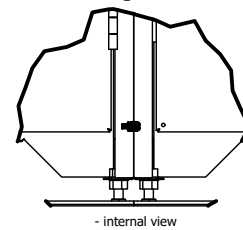

### Leveling Straps

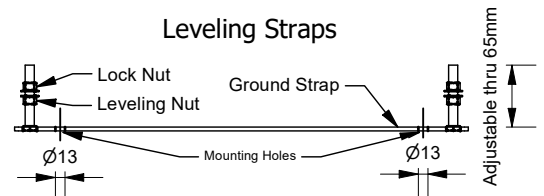

Adjust leveling straps opposite doors first

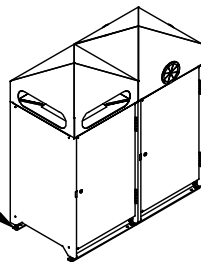

Adjust leveling straps under doors

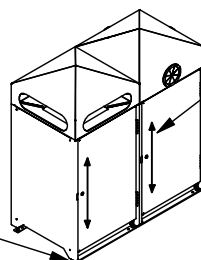

Ensure all door gaps are parallel and even using leveling straps

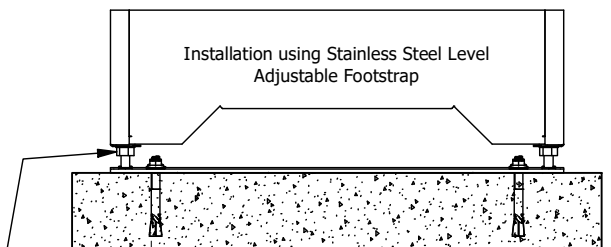

\*M10 anchors recommended for installation at a depth recommended by your site engineer

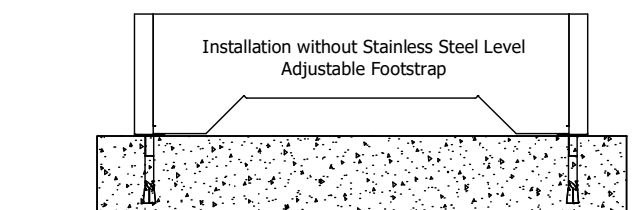

\*M10 anchors recommended for installation at a depth recommended by your site engineer