

900 Series Sloped Cover 120lt Bin Surround

Model 911 - 900 Series Sloped Cover 120lt Bin Surround

DRAFFIN
Street Furniture



900 series Sloped Cover Bin Surrounds offer single side access to the opening while keeping the weather out, with several opening styles. 900 Series Bin Surrounds have a fully welded frame for strength and are clad with battens or recycled HDPE panels to soften their appearance.

Size

- 120lt

Cover Style

- Sloped Cover

Cover Material

- Powdercoated Mild Steel (See Colour Guide)
- 304 Stainless Steel
- 316 Stainless Steel

Cover Opening

- Frogmouth
- Recycle Escutcheon (Rubber Rosette)
- Recycle (without Rubber Rosette)

Frame Material

- Powdercoated Mild Steel (See Colour Guide)
- 304 Stainless Steel
- 316 Stainless Steel

Batten Material (See Batten Guide)

65mm x 19mm

- Spotted Gum
 - Enviroslat
 - Anodised Aluminium
 - Powdercoated Aluminium (See Colour Guide)
 - Timber-Look Aluminium - Alpine Ash
 - Timber-Look Aluminium - Mountain Gum
 - Timber-Look Aluminium - Ironbark
- or
- Recycled HDPE Panels - Plain (See Recycled Plastic Colour Guide)
 - Recycled HDPE Panels - Routed Pattern (See Pattern Guide)

Other Options

- Communication Signage (See Signage Guide)
- Cover Face Plates
- Dog Bag Dispenser (External Mounted - Model 88737)

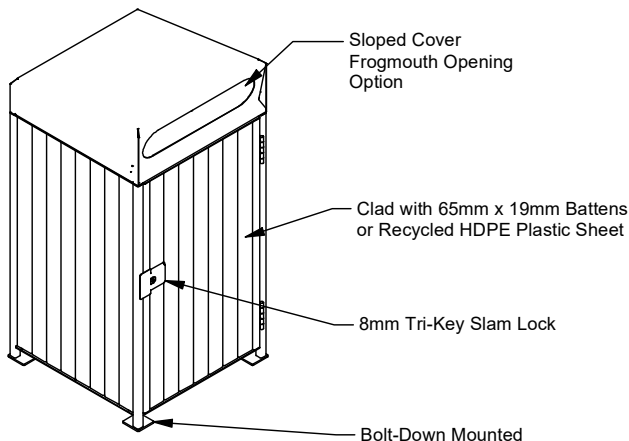
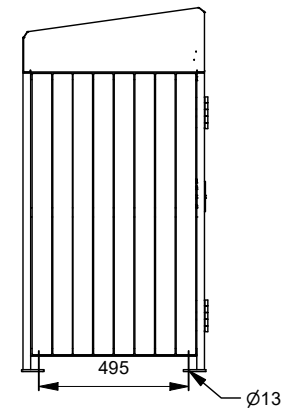
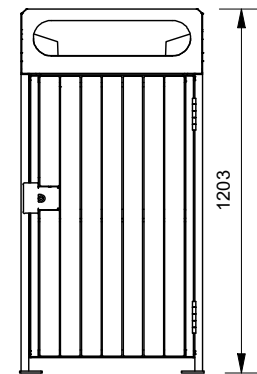
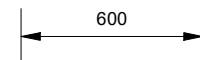
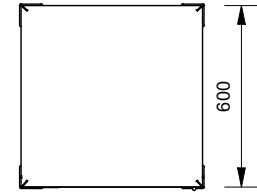

More information:
Go to the website for spec inspiration.

911 - 120lt 900 Series Sloped Cover Bin Surround
<https://draffin.com.au/product/sloped-900-series-timber-clad-bin-surrounds/>

Colour Guide
<https://draffin.com.au/colour-guide/>

Signage Guide
<https://draffin.com.au/signage-guide/>

Batten Guide
<https://draffin.com.au/batten-guide/>

Stainless Steel Guide
<https://draffin.com.au/stainless-steel-guide/>

Recycled HDPE Plastic Guide
<https://draffin.com.au/recycled-plastic-colour-chart/>

900 Series Sloped Cover 120lt Bin Surround

Model 911 - 900 Series Sloped Cover 120lt Bin Surround



Signage options for 900 Series Bin Surrounds

Sign panel variations including sticker

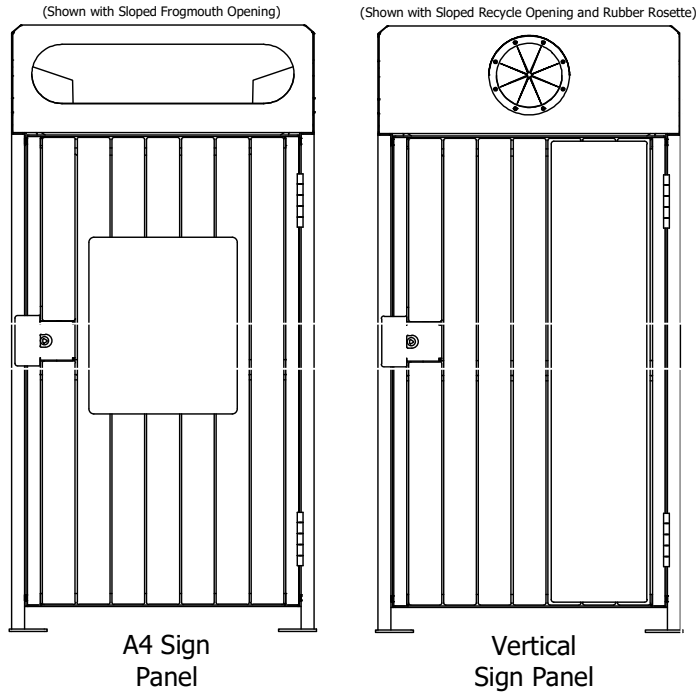

120lt Sloped Cover Openings

Frogmouth Opening

with angled chute to direct refuse into wheelie bin

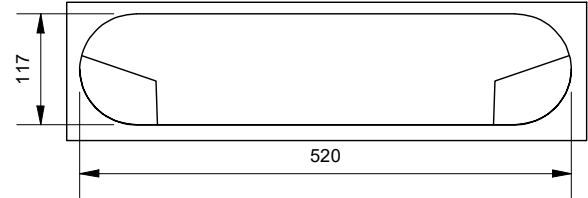

Recycle Opening with Rosette

with Heavy-Duty rubber escutcheon

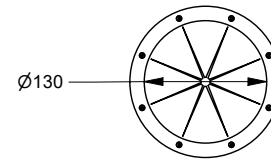

Recycle Opening without Rosette

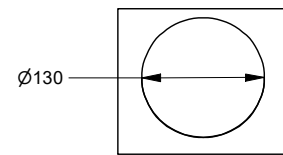

HDPE Recycled Plastic Panels

(In place of battens)

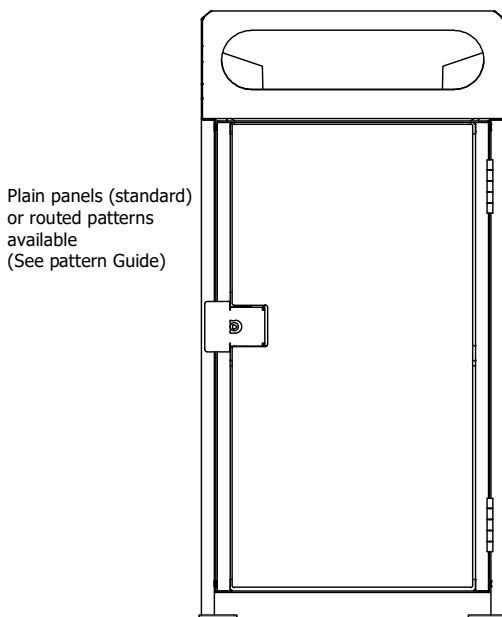

Plain panels (standard)
or routed patterns
available
(See pattern Guide)

Installation Detail

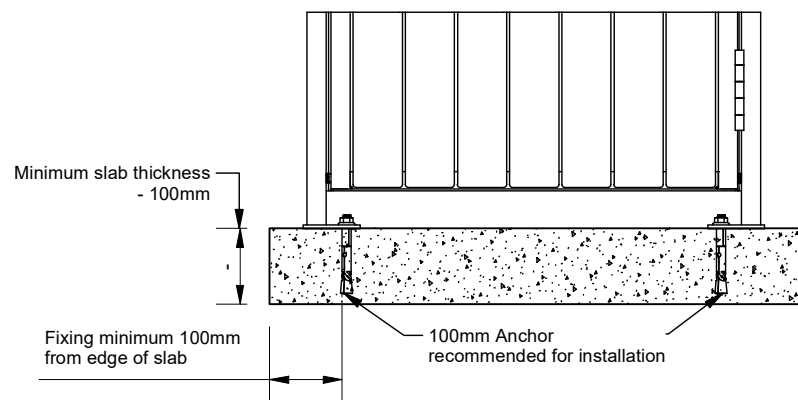

900 Series Sloped Cover 240lt Bin Surround

Model 931 - 900 Series Sloped Cover 240lt Bin Surround

DRAFFIN
Street Furniture



900 series Sloped Cover Bin Surrounds offer single side access to the opening while keeping the weather out, with several opening styles. 900 Series Bin Surrounds have a fully welded frame for strength and are clad with battens or recycled HDPE panels to soften their appearance.

Size

- 240lt

Cover Style

- Sloped Cover

Cover Material

- Powdercoated Mild Steel (See Colour Guide)
- 304 Stainless Steel
- 316 Stainless Steel

Cover Opening

- Frogmouth
- Recycle Escutcheon (Rubber Rosette)
- Recycle (without Rubber Rosette)

Frame Material

- Powdercoated Mild Steel (See Colour Guide)
- 304 Stainless Steel
- 316 Stainless Steel

Batten Material (See Batten Guide)

65mm x 19mm

- Spotted Gum
 - Enviroslat
 - Anodised Aluminium
 - Powdercoated Aluminium (See Colour Guide)
 - Timber-Look Aluminium - Alpine Ash
 - Timber-Look Aluminium - Mountain Gum
 - Timber-Look Aluminium - Ironbark
- or
- Recycled HDPE Panels - Plain (See Recycled Plastic Colour Guide)
 - Recycled HDPE Panels - Routed Pattern (See Pattern Guide)

Other Options

- Communication Signage (See Signage Guide)
- Cover Face Plates
- Dog Bag Dispenser (External Mounted - Model 88737)

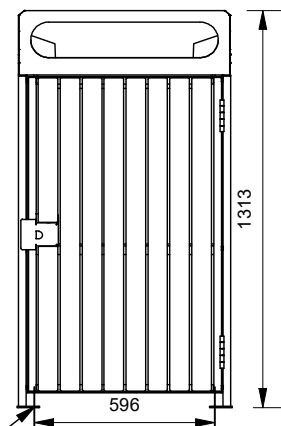
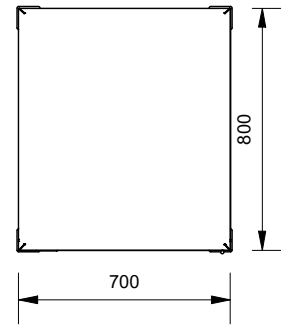

Ø13

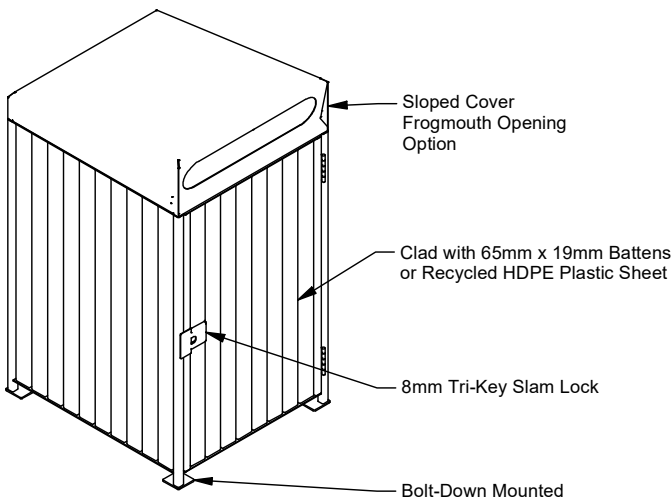
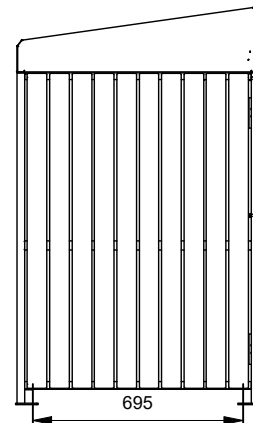

More information:
Go to the website for spec inspiration.

931 - 240lt 900 Series Sloped Cover Bin Surround
<https://draffin.com.au/product/sloped-900-series-timber-clad-bin-surrounds/>

Colour Guide
<https://draffin.com.au/colour-guide/>

Signage Guide
<https://draffin.com.au/signage-guide/>

Batten Guide
<https://draffin.com.au/batten-guide/>

Stainless Steel Guide
<https://draffin.com.au/stainless-steel-guide/>

Recycled HDPE Plastic Guide
<https://draffin.com.au/recycled-plastic-colour-chart/>

900 Series Sloped Cover 240lt Bin Surround

Model 931 - 900 Series Sloped Cover 240lt Bin Surround



Signage options for 900 Series Bin Surrounds

Sign panel variations including sticker

(Shown with Sloped Cover with Frogmouth Opening)

(Shown with Sloped Cover Recycle Opening with Rubber Rosette)

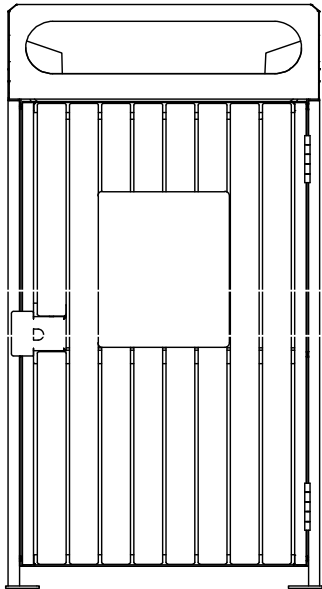

A4 Sign Panel

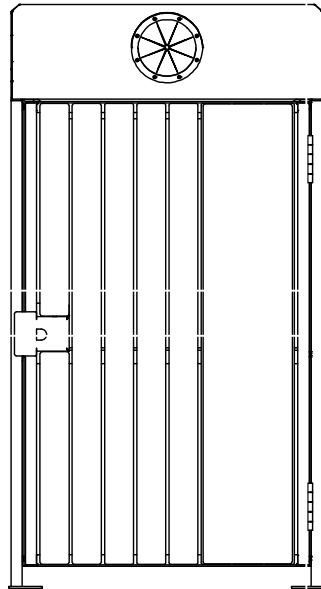

Vertical Sign Panel

240lt Sloped Cover Openings

Frogmouth Opening

with angled chute to direct refuse into wheelie bin

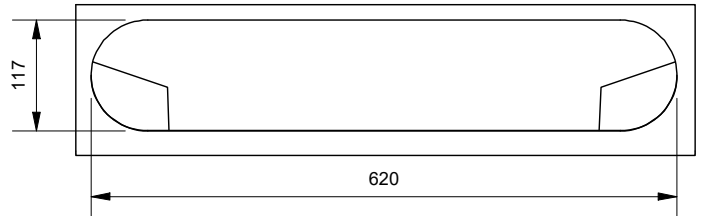

Recycle Opening with Rosette

with Heavy-Duty rubber escutcheon

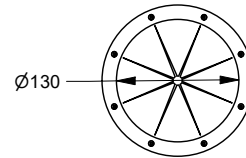

Recycle Opening without Rosette

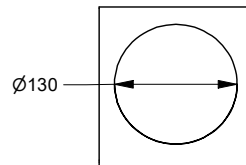

HDPE Recycled Plastic Panels

(In place of battens)

Plain panels (standard) or routed patterns available (See pattern Guide)

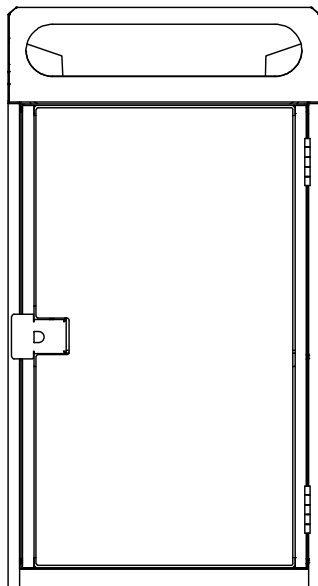

Installation Detail

Minimum slab thickness - 100mm

Fixing minimum 100mm from edge of slab

100mm Anchor recommended for installation

